

DASH NO	TYPE OR MODEL	NEXT ASSEMBLY
3800		

D 03-925673-00

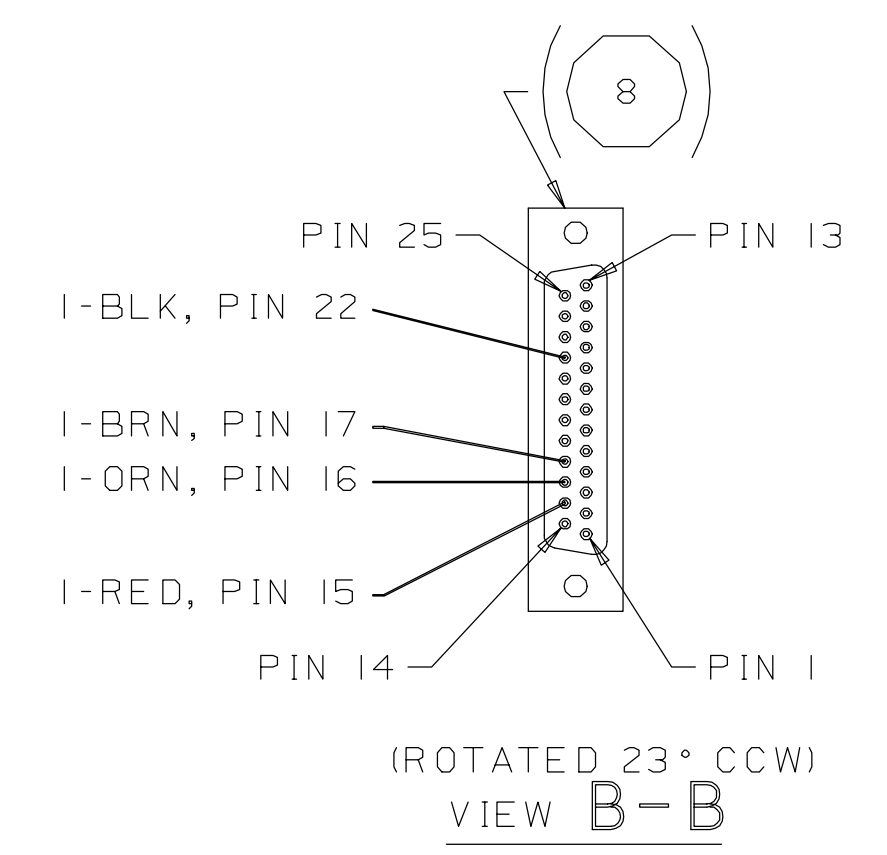

STRT LG	TERM NO.	FROM	TO	TERM NO.	STR LG	U/M	REQ	PART NUMBER	DESCRIPTION OR MATERIAL	ITEM
	LSC-3	P4/5-17						81-742212-00	CABLE, 4 COND, 22 AWG, SHLD	1
	LSC-4	P4/5-16							WIRE, BRN	
	LSC-21	P4/5-22							WIRE, ORN	
	LSC-22	P4/5-15							WIRE, BLK	
									WIRE, RED	
									DRAIN WIRE	
							IN	81-742203-00	CABLE, 7 COND, 24 AWG, SHLD	2
	LSC-23	PI-2							WIRE, BRN	
	LSC-24	PI-15							WIRE, GRN	
	LSC-1	PI-5							WIRE, RED	
	LSC-2	PI-18							WIRE, WHT	
	LSC-16	PI-14							WIRE, BLU	
	LSC-15	PI-1							WIRE, BLK	
									WIRE, ORN	
									DRAIN	

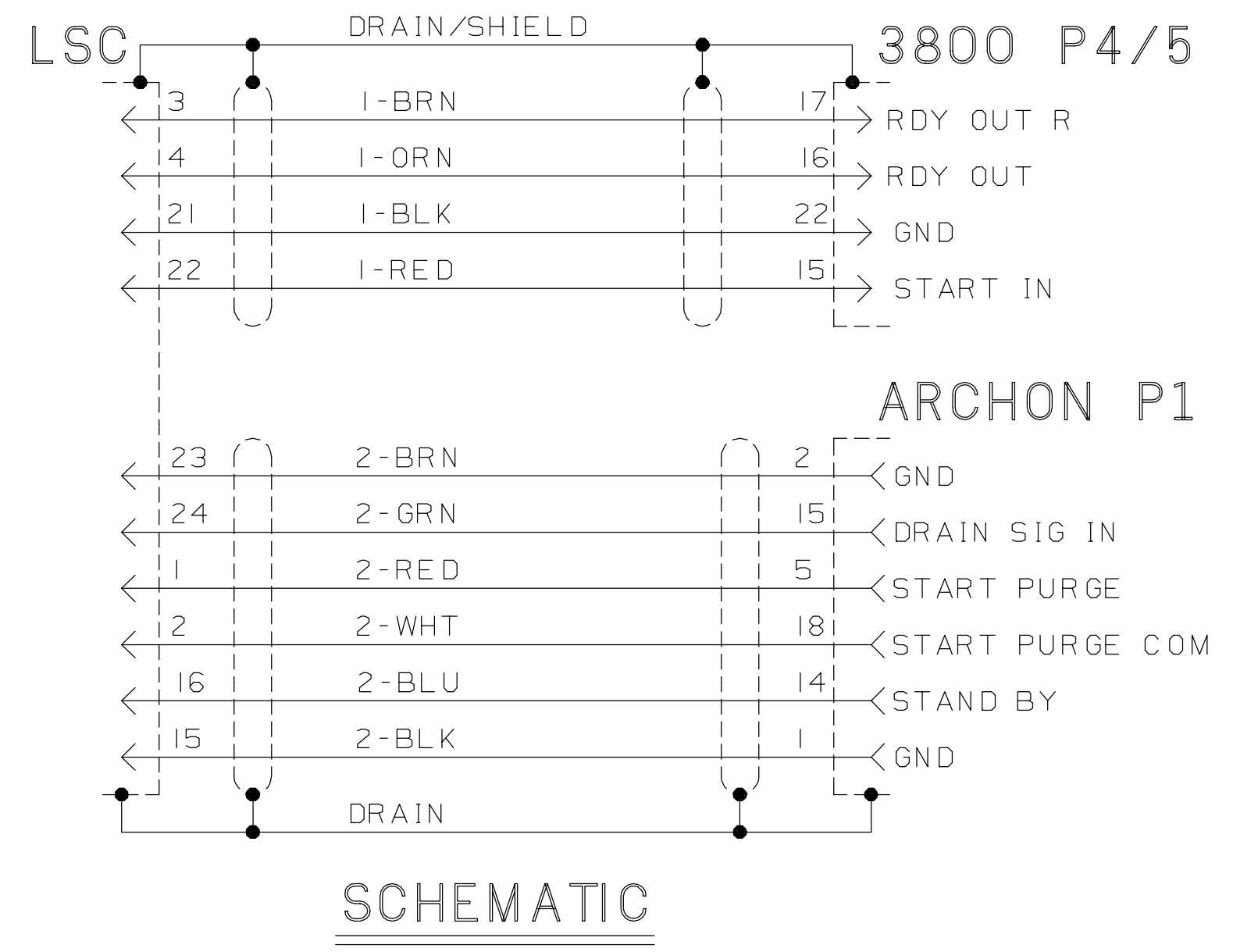
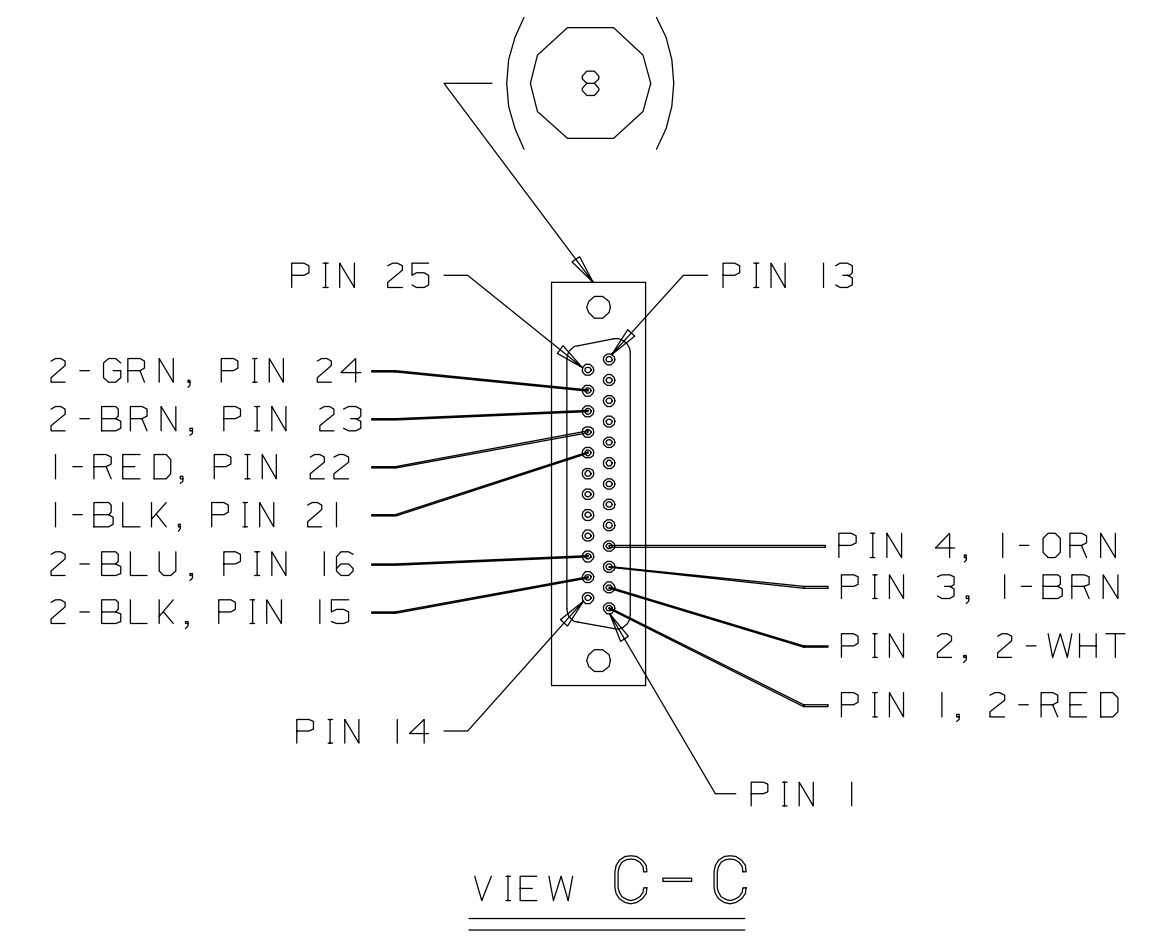

2-GRN, PIN 24  
2-BRN, PIN 23  
1-RED, PIN 22  
1-BLK, PIN 21  
2-BLU, PIN 16  
2-BLK, PIN 15  
PIN 4, 1-ORN  
PIN 3, 1-BRN  
PIN 2, 2-WHT  
PIN 1, 2-RED

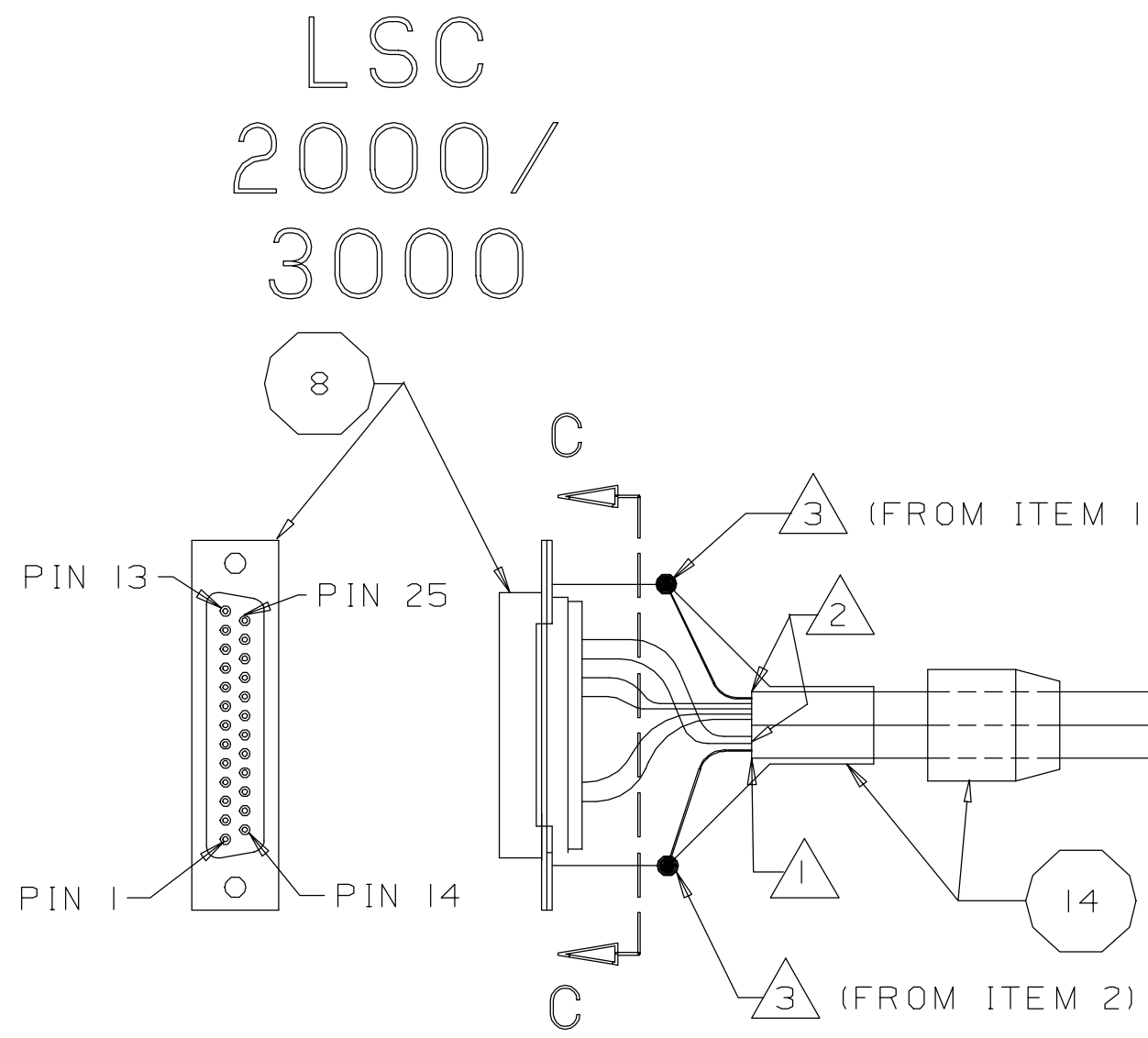

- 6. MARK BOTH SIDES OF LABEL (ITEM 17) WITH PART NUMBER, NAME AND REVISION LEVEL OF ASSY, THEN LOCATE ON THE CABLE, AS SHOWN.
  - 5. FOLD CABLE SHIELD BRAID BACK ON SMALL DIAMETER PORTION OF "COMPRESSION INSERT" (PART OF ITEM 15) BEFORE INSTALLING IT BETWEEN BACK SHELL HALVES ITEM 15. CUT DRAIN WIRE FLUSH WITH CABLE JACKET.
  - 4. CUT INSULATING JACKET AWAY, AS SHOWN. DO NOT DAMAGE BRAIDED SHIELD.
  - 3. SOLDER DRAIN WIRES TO TABS ON METAL BACKSHELL (ITEM 14).
  - 2. CUT THE BRAID AND/OR FOIL FLUSH WITH CABLE JACKET.
  - 1. CUT ORG WIRE (PART OF ITEM 2) FLUSH WITH JACKET.
- NOTES:

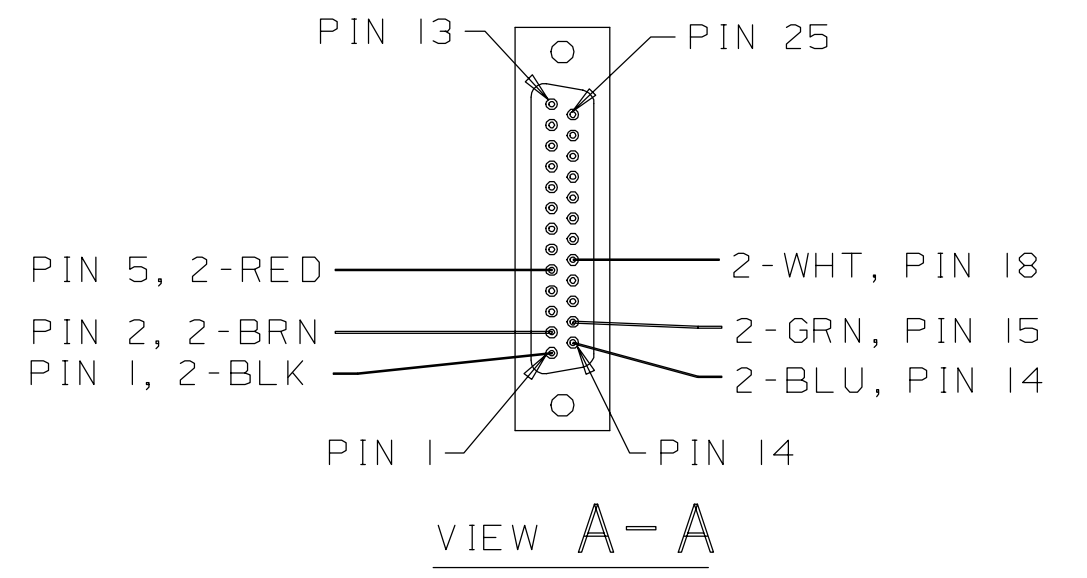
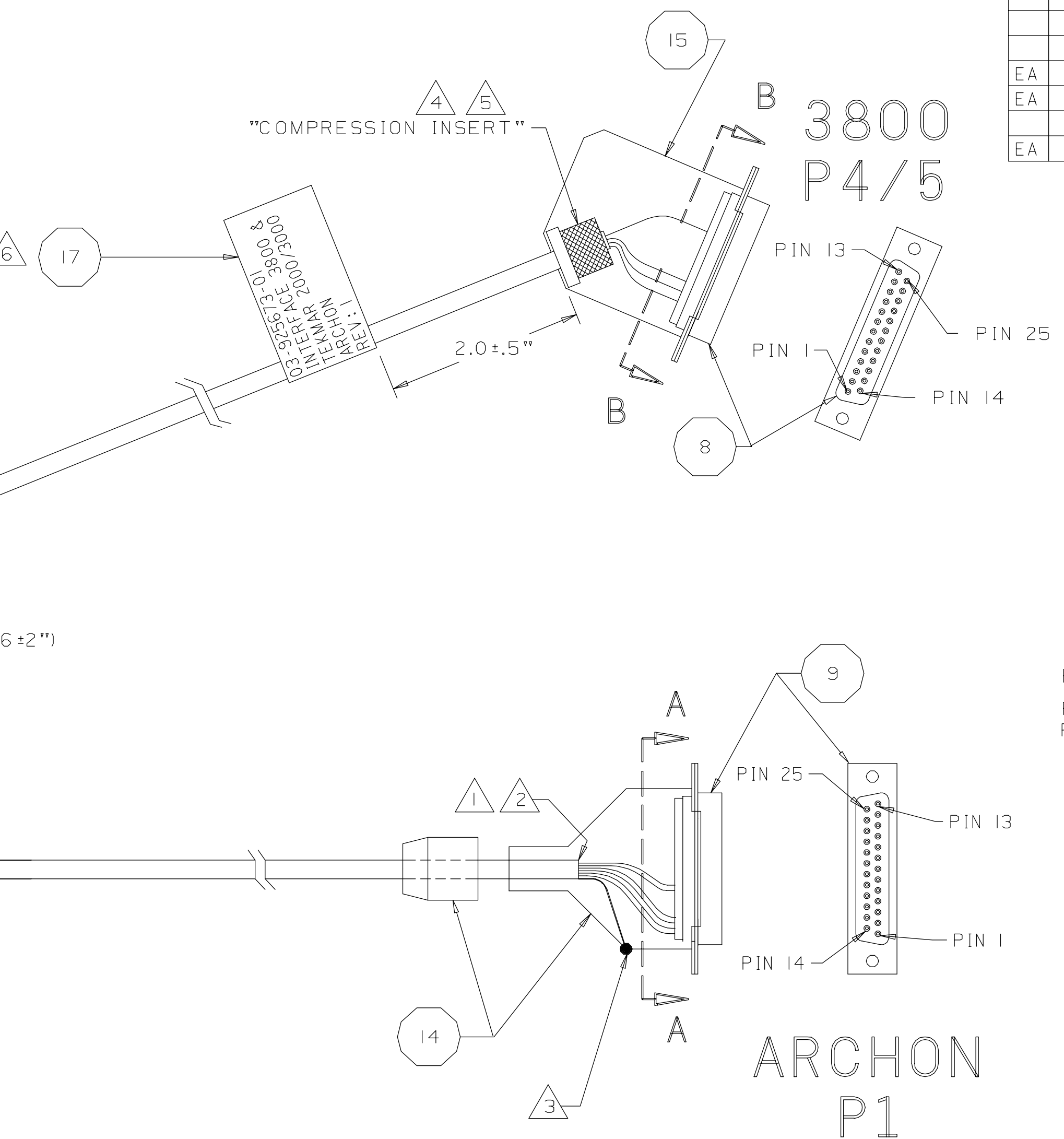

-01	ASSY
-00	DRAWING ONLY
DASH NO. DESCRIPTION	
DRAWN	DATE APPROVED DATE CODE
JCK	14 MAR 97
CHECKED	DATE APPROVED DATE CLASS
ASSY, CABLE, INTERFACE 3800 TO TEKMAR 2000/3000/ARCHON	
NOT OTHERWISE SPEC: ANG±	
FIN.	DEC .X ± .XX ± .XXX ±
I/I	38 I OF I D 03-925673-00
SCALE	DIV SHEET SIZE DRAWING NO REV

DESCRIPTION OF CHANGE	APVD	
	EO	
	DFT	
	CHK	
DATE		
REV		